



AT&T Generator Platform Ordering Guide



1-800-453-0050

www.emiproductions.com

11230 Neeshaw Drive, Houston, Texas 77065



Overview:

All generator platform solutions are designed to accommodate all generators up to 50KW. These platforms can handle sizes up to 95"X38"X101" and an operating weight of 6,500 lbs.

The on-grade platform arrives fully assembled from the factory, making installation a breeze. With gravity feet that can be placed on-grade without any anchoring, the installation time and material costs are significantly reduced. Generator placement at any site can be completed within a couple of hours using this platform solution.

There are two elevated Platform models available: 0567 and 0571. Both models offer elevations ranging from 4' to 20' in 2' increments. For access options, we provide standard and preferred stairs with landings or a gated safety ladder for locations with real estate constraints. Additionally, the optional THERN 500 lb. crane makes refueling and other service functions much easier.

192" x 120" Generator up to 50 kW Elevated Platform with Stairs

Part Number	Elevation
AT&T- CEQ.65649 EMI- 1000-0010-0567-04 ↓	4 ft
AT&T- CEQ.65663 EMI- 1000-0010-0567-06 ↓	6 ft
AT&T- CEQ.65652 EMI- 1000-0010-0567-08 ↓	8 ft
AT&T- CEQ.65657 EMI- 1000-0010-0567-10 ↓	10 ft
AT&T- CEQ.65658 EMI- 1000-0010-0567-12 ↓	12 ft
AT&T- CEQ.65651 EMI- 1000-0010-0567-14 ↓	14 ft
AT&T- CEQ.65659 EMI- 1000-0010-0567-16 ↓	16 ft
AT&T- CEQ.65665 EMI- 1000-0010-0567-18 ↓	18 ft
AT&T- CEQ.65654 EMI- 1000-0010-0567-20 ↓	20 ft

↓ Click the EMI part number to download drawing.

Description

Generator up to 50 kW elevated platform kit, 192"x 120" up to 50KW Genset. Includes stairs and landings. Helical foundations not included.

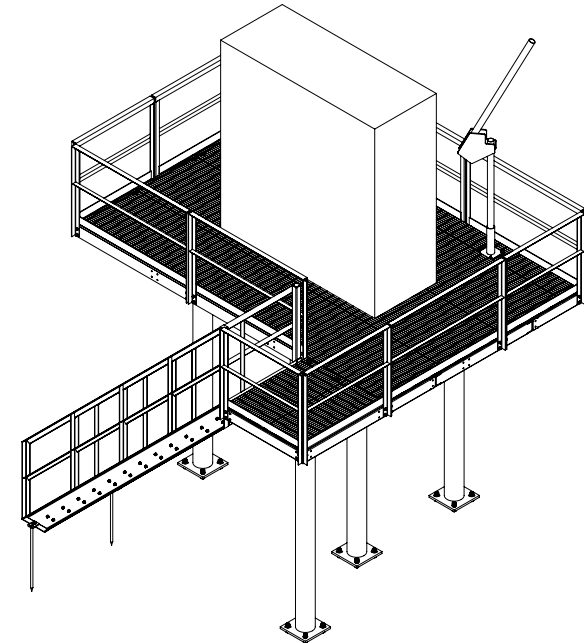

Part Number
AT&T- CEQ.65650 EMI- 1000-0030-0251 ↓
Description
Thern 500 lb. Ensign Series Davit crane, model 5PA5-M1 powder coated crane with hand winch (M4022PB-K) and 5bp5 pedestal base (powder coated)
Part Number
AT&T- CEQ.65668 EMI- 1000-0030-0253 ↓
Description
Quantity of 5, 10"x21' Triple Flight Helical Anchor Kit

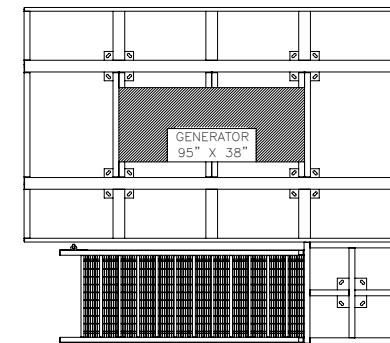
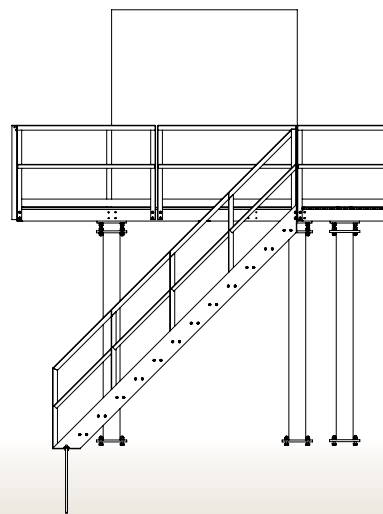

192" x 120" Generator up to 50 kW Elevated Platform w/ Ladder [Non-Standard Option] *Order only for real-estate constraint sites*

Part Number	Elevation
AT&T- CEQ.65656 EMI- 1000-0010-0571-04 ↓	4 ft
AT&T- CEQ.65661 EMI- 1000-0010-0571-06 ↓	6 ft
AT&T- CEQ.65653 EMI- 1000-0010-0571-08 ↓	8 ft*
AT&T- CEQ.65660 EMI- 1000-0010-0571-10 ↓	10 ft*
AT&T- CEQ.65662 EMI- 1000-0010-0571-12 ↓	12 ft*
AT&T- CEQ.65655 EMI- 1000-0010-0571-14 ↓	14 ft*
AT&T- CEQ.65648 EMI- 1000-0010-0571-16 ↓	16 ft*
AT&T- CEQ.65647 EMI- 1000-0010-0571-18 ↓	18 ft*
AT&T- CEQ.65664 EMI- 1000-0010-0571-20 ↓	20 ft*

↓ Click the EMI part number to download drawing.

Description

Generator up to 50 kW elevated platform kit, 192"x 120" up to 50KW Genset. Includes entry ladder (and safety climb arrest above 6 ft elevation). Helical foundations not included.
*Includes safety climb system.

Part Number

AT&T- CEQ.65650 EMI- [1000-0030-0251](#) ↓

Description

Thern 500 lb. Ensign Series Davit crane, model 5PA5-M1 powder coated crane with hand winch (M4022PB-K) and 5bp5 pedestal base (powder coated)

Part Number

AT&T- CEQ.65668 EMI- [1000-0030-0252](#) ↓

Description

Quantity of 4, 10"x21' Triple Flight Helical Anchor Kit

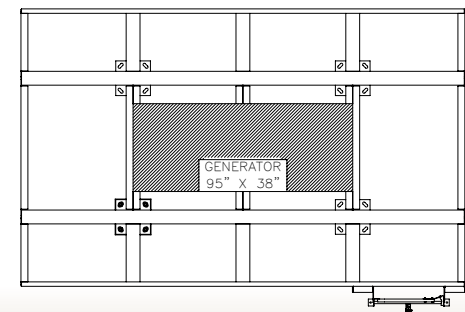
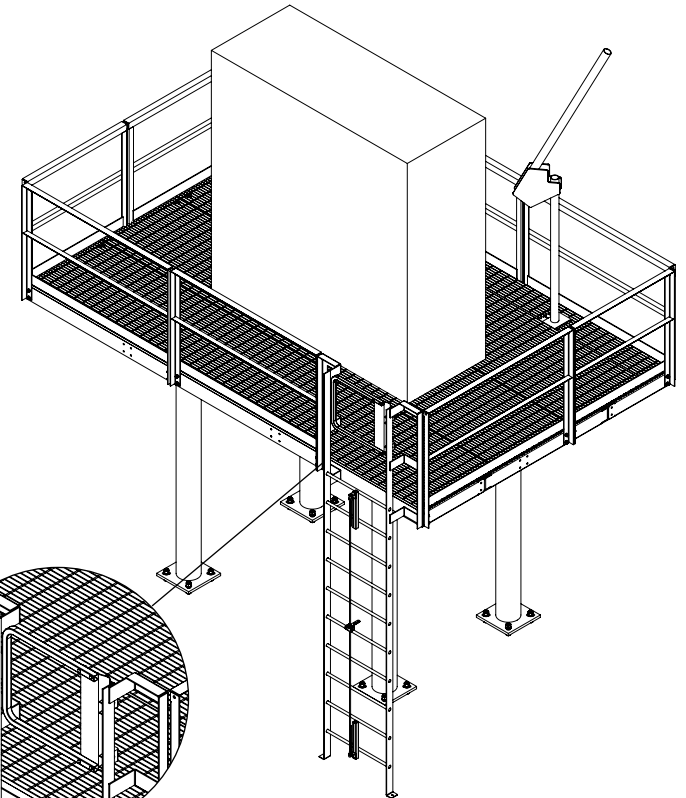
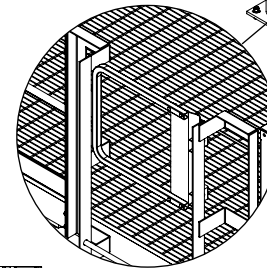
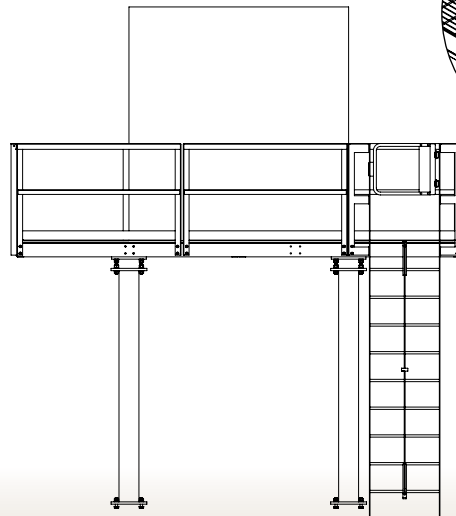

102" x 75" Generator up to 50 kW Gravity/Pad Mount Platform

Part Number

AT&T- CEQ.54437 **EMI-** [1010-0010-0118](#) ↓

↓ Click the **EMI** part number to download drawing.

Description

Generator up to 50 kW gravity mount platform assembly 102" x 75" with steel grating and leveling feet.

Single Step Kit Sold Separately

Part Number

AT&T- CEQ.51664 **EMI-** [1003-0000-0020](#) ↓

↓ Click the **EMI** part number to download drawing.

Description

Single step stair kit 45 degree including hardware.

156" x 106" 50 kW Genset Gravity/Pad Mount Platform

Part Number

AT&T- CEQ.48196 **EMI-** [1010-0010-0171](#) ↓

↓ Click the **EMI** part number to download drawing.

Description

Generator up to 50 kW gravity mount platform kit 156" x 106" with 1" steel grating and 8 leveling feet grade level.

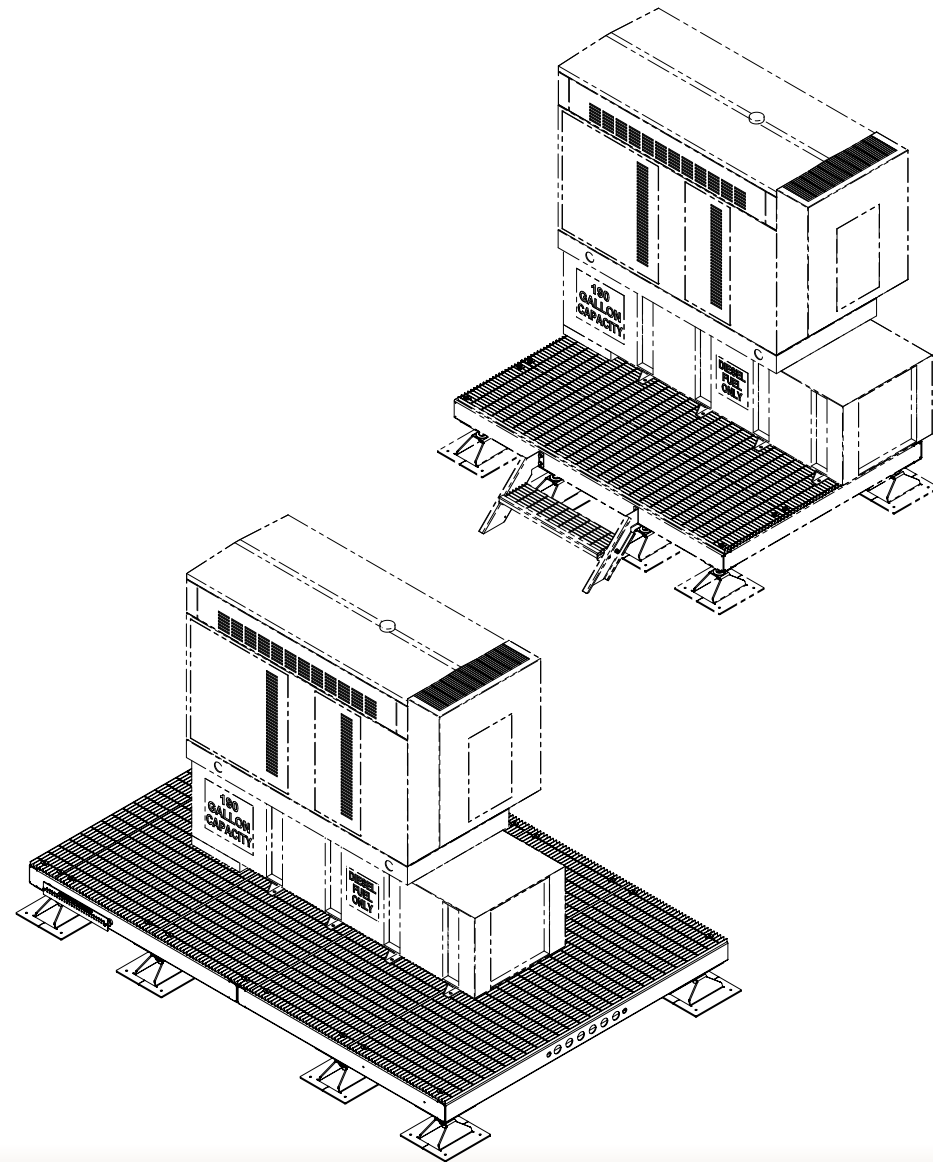

9' x 4' Pad Mount Generator Platform

This 9' x 4' platform is designed for all ATT approved generators up to the Generac 30kW diesel. The generator should be installed in the center of the platform or in any orientation the will fit. Grounding locations are on all four sides to support any site layout. Platform includes a rodent guard for all generators that need it.

Part Number

AT&T- CEQ.53672 EMI- [1001-0020-0062](#) ↓

↓ Click the EMI part number to download drawing.

Description

Gravity mount generator platform with adjustable feet.

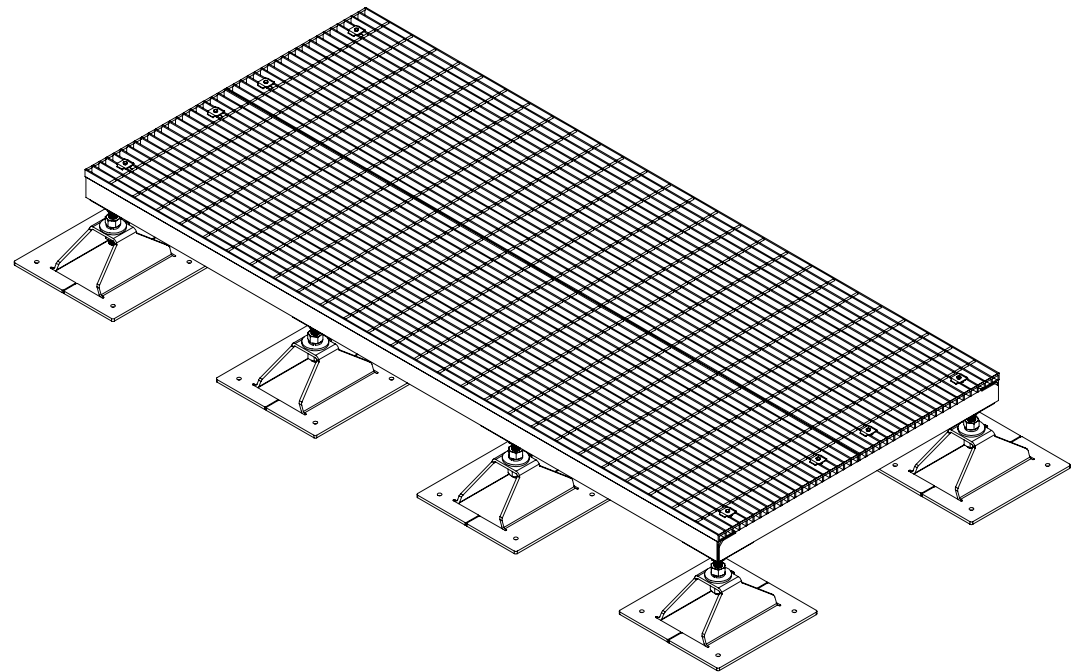

SHOWN WITHOUT GRATING

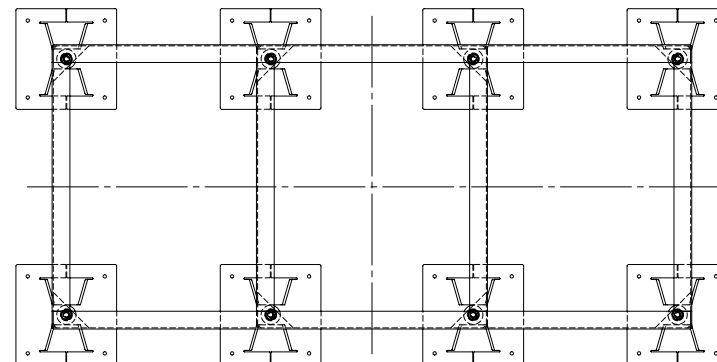

53" x 35" Vertical Polar Generator Helical Mount Plinth

This two helical generator platform utilizes the same helices used on the WIC. Grounding locations are on four sides to accommodate any site layout. It is specifically designed for the vertical Polar generator.

Part Number

AT&T- CEQ.53652 EMI- [1000-0010-0075](#) ↓

↓ [Click the EMI part number to download drawing.](#)

Description

Vertical Polar generator plinth 53" x 35" kit with 6" dia. x 7' high helical foundations and leveling hardware.

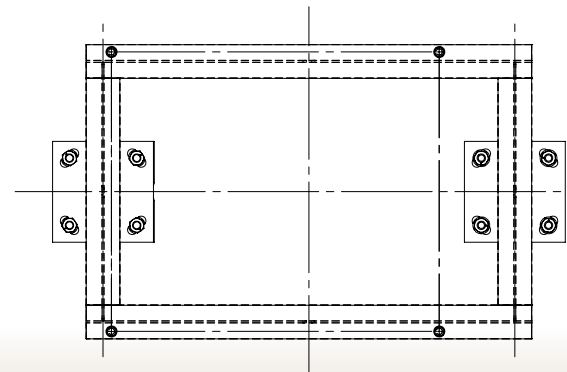
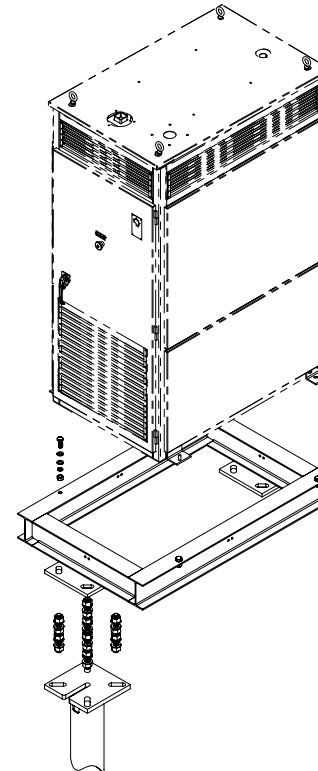

72" x 53" Helical Mount Generator Platform

One of these platforms will accommodate all generators up to 20kW. Grounding locations are on all sides to support any site layout. Platform includes a rodent guard for generators that need it.

Part Number

AT&T- CEQ.53665 EMI- [1000-0010-0109](#) ↓

↓ [Click the EMI part number to download drawing.](#)

Description

Generator platform kit 72" x 53" with 6" dia. x 7' high helical foundations and leveling hardware.

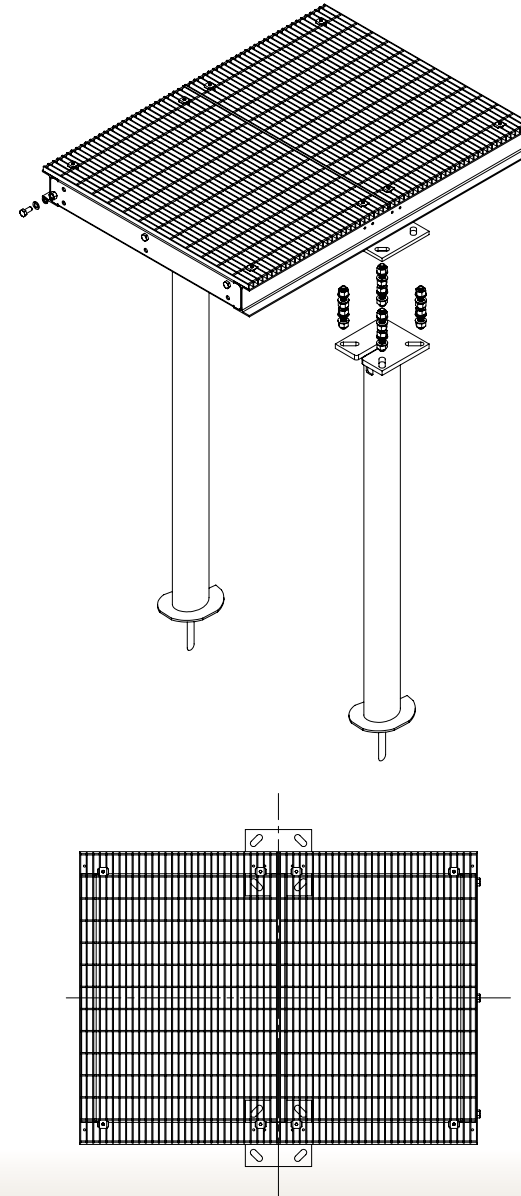

144" x 53" Helical Mount Generator Platform

Two of these platforms bolted together will accommodate generators up to 30kW. Grounding locations are on three sides to support any site layout. Platform includes rodent guard for generators that need it. All hardware provided.

Part Number

AT&T- CEQ.53665 X2 EMI- [1000-0010-0109](#) X2 ↓

↓ Click the EMI part number to download drawing.

Description

Generator platform kit 144" x 53" with 6" dia. x 7' high helical foundations and leveling hardware.

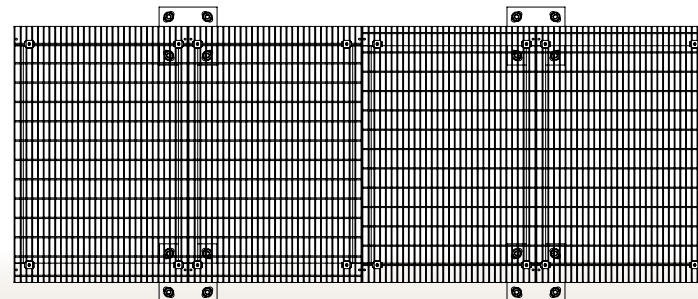
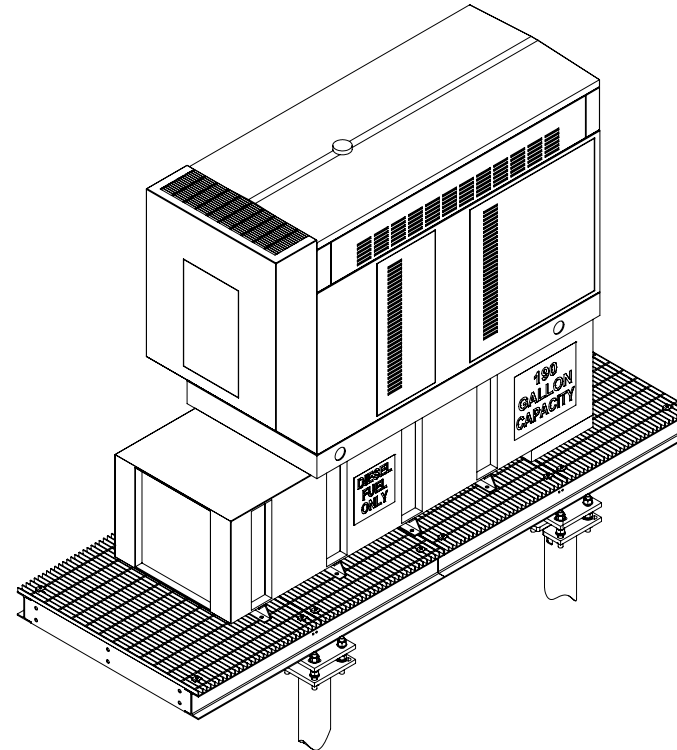

53" x 36" Vertical Generator Pad Mount Plinth

Part Number

AT&T- CEQ.53678

EMI- [1000-0000-0115](#) ↓

↓ Click the **EMI** part number to download drawing.

Description

Vertical generator plinth for concrete mount 53" x 36" with anchor base plates and leveling hardware.

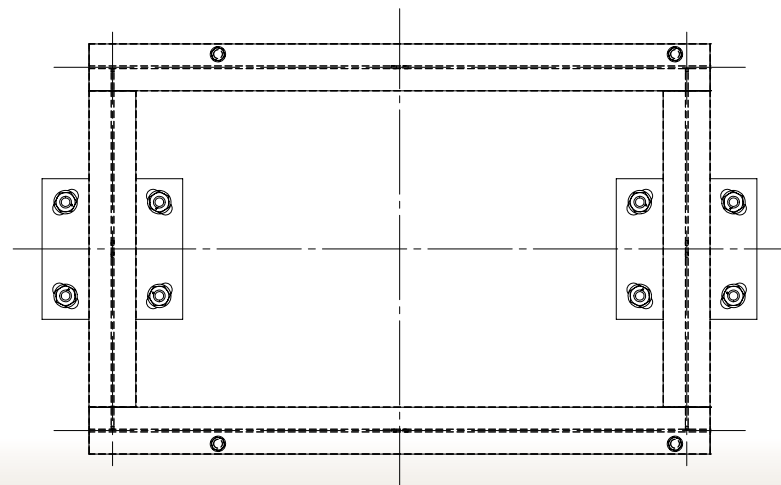
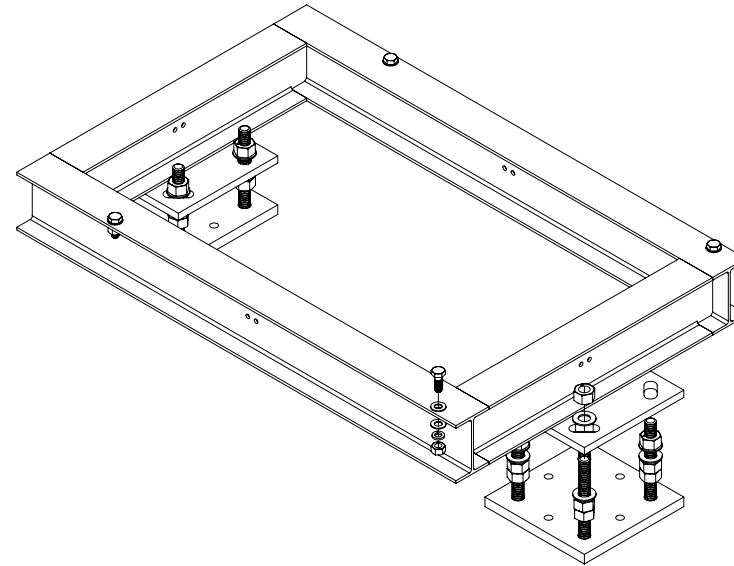

228" x 43 3/8" Generator Plinth Kit

Part Number

AT&T- NEQ.20738

EMI- W-000-954 ↓

↓ Click the EMI part number to download drawing.

Description

Generator rail plinth kit 228" x 43 3/8" platform. Includes genset clamp kit, grating and ground bar kit.

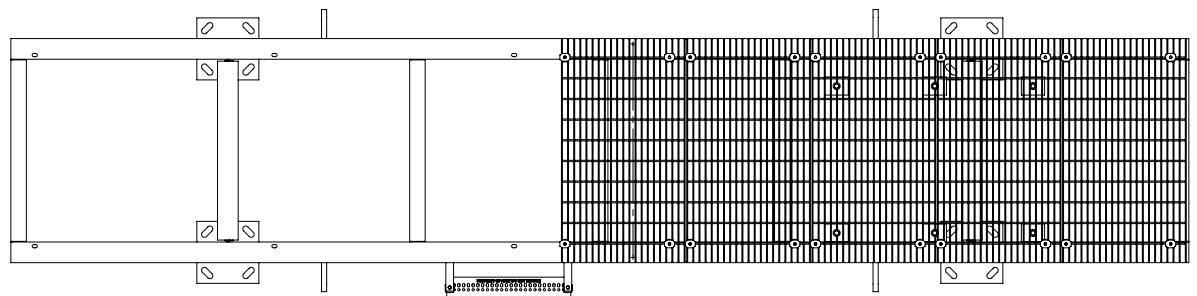
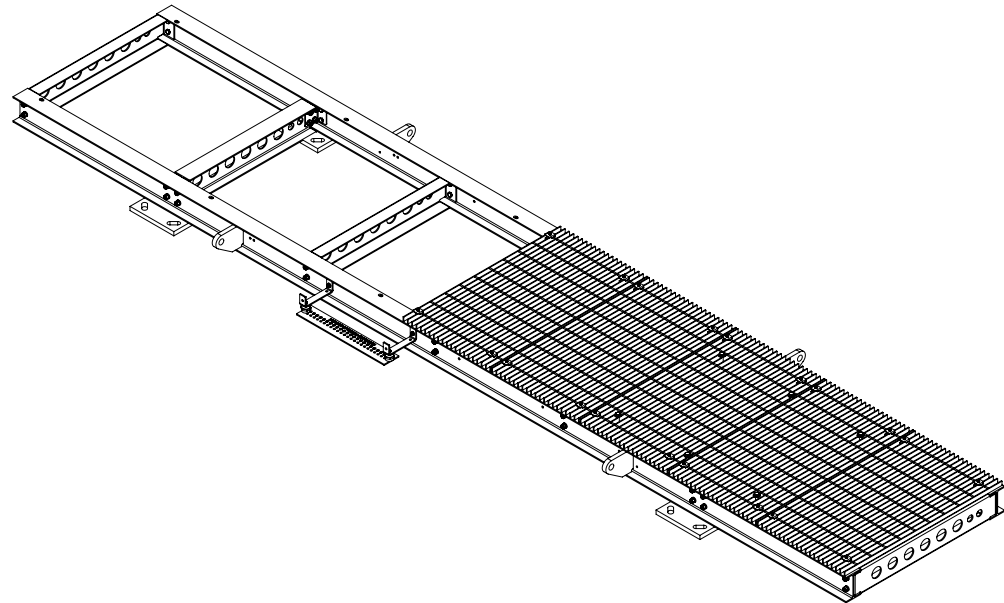

48" x 48" WUC Gravity/Pad Mount Platform for Growth

Part Number

AT&T- CEQ.59358 **EMI-** [1000-0030-0203](#) ↓

↓ [Click the EMI part number to download drawing.](#)

Description

48" x 48" WUC/genset gravity mount platform kit with 1" steel grating and 4 leveling feet grade level.

